

## Installation Manual Double DIN Kit

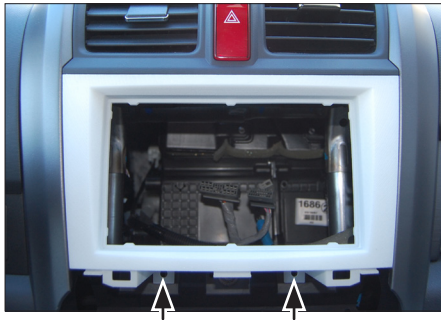

7. Place the new facia plate.

Fix it with two screws (see arrows)

Push the metal frame into the facia plate

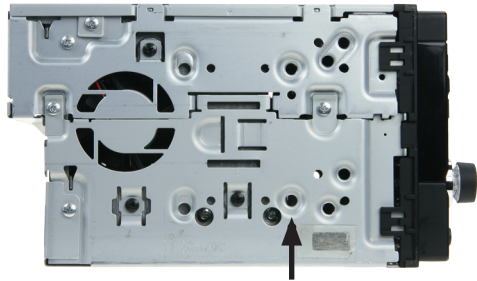

Mount the metal brackets with the double DIN head unit

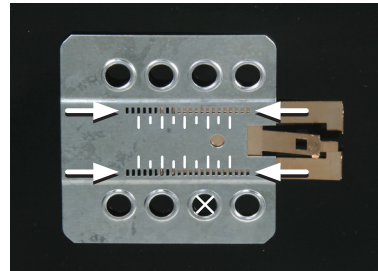

The position of the copper coloured holder can be adjusted to your needs for perfect fit. (see sample)



8. Connect all required circuit points and push the double DIN head unit in the metal frame until it snaps in.

Place the trim frame

Reinstall everything in reverse order



## Installation Manual Double DIN Kit

Standard: 381130-07

Rubber-Touch: 391130-07

### • Honda CR-V 2006 ->

Compatible with double DIN devices

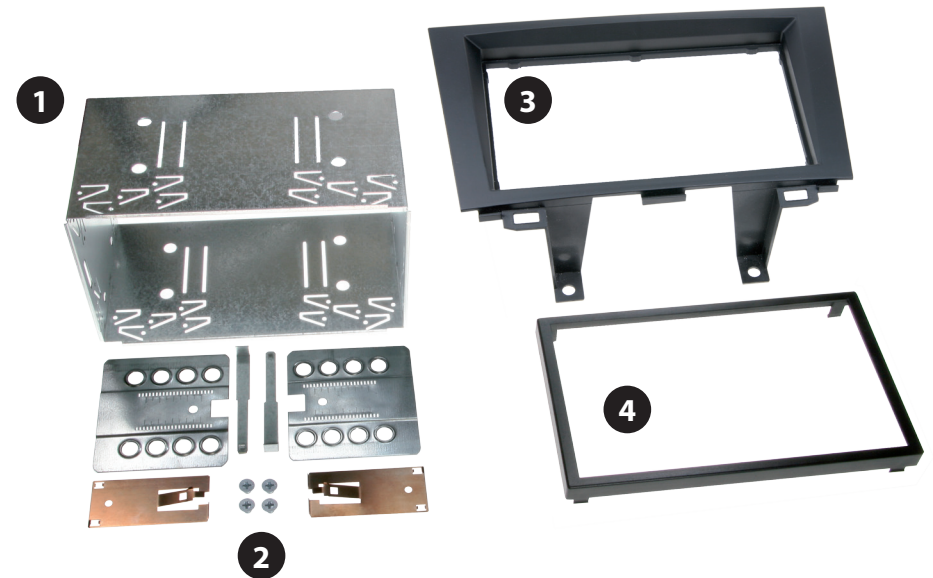

Double DIN Set contents

- (1) Metal Frame
- (2) Installation Kit

- (3) Facia Plate
- (4) Trim Frame

## Installation Manual Double DIN Kit 381130-07 / 391130-07



1. Honda CR-V with OEM head unit



4. Remove the air vent unit



2. Unclip the air condition control unit and remove it

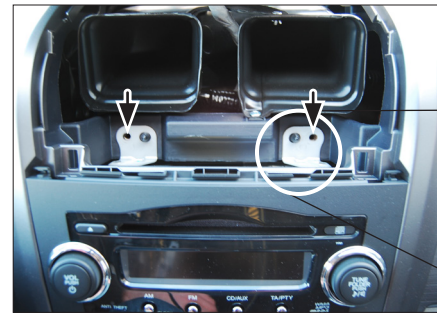

5. Remove the two screws above the OEM head unit

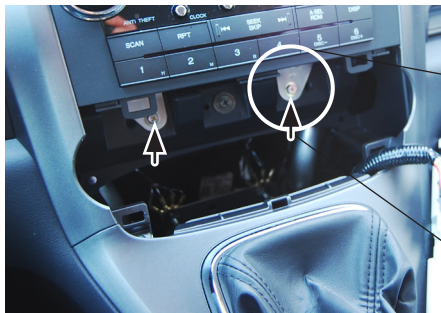

3. Remove the two screws below the OEM head unit



6. Remove the OEM head unit

All installation work must be performed by a qualified professional installer only.  
The manufacturer / dealer is not liable for any kind of incidental or indirect damages.