

## FITTING GUIDE

---

1. We would recommend using your hands or plastic tools and low tack masking tape to avoid damage to the panel. Please remove the panel with a secure grip as shown on the image below



2. Once the panel is removed please extract the screws and the Radio as shown on the images below



**Fascia and aftermarket Radio**



**8. Connect the USB adapter to the back of the Radio**

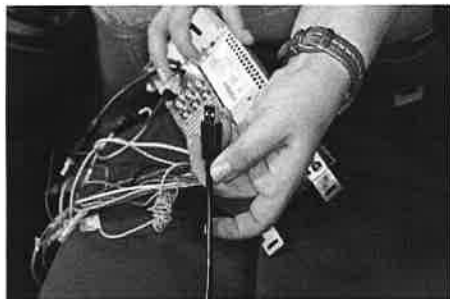

**9. Dashboard USB connection**



**10. Connect the aerial**

**11. Attach the brackets to the Radio and Fascia**

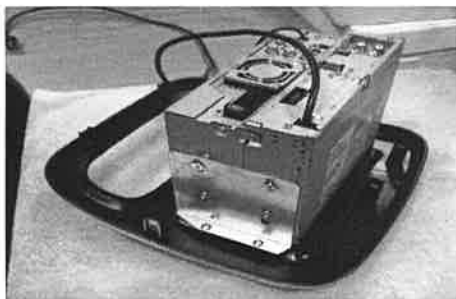

**12. Once all the connections are in place, insert the new Radio carefully in the dash to avoid damage to the leads. We recommend to try the Radio is working before the screws and fascia are fitted**

**7. Connect the interface between Radio and Car Harness (image 6) as shown on the images below**

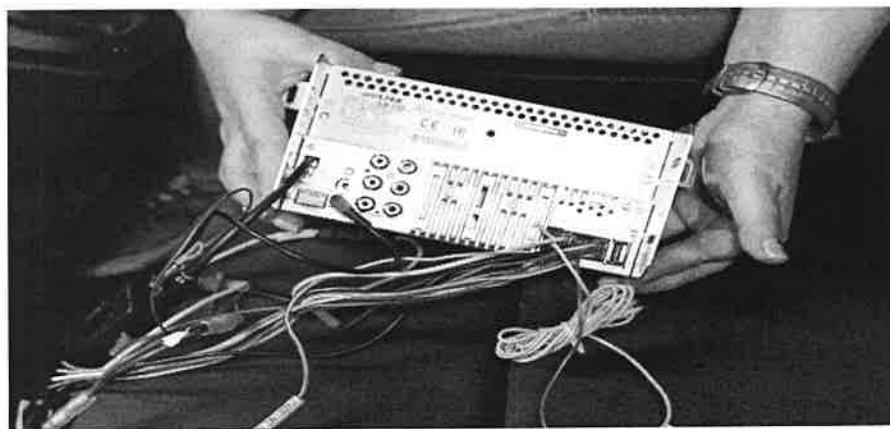
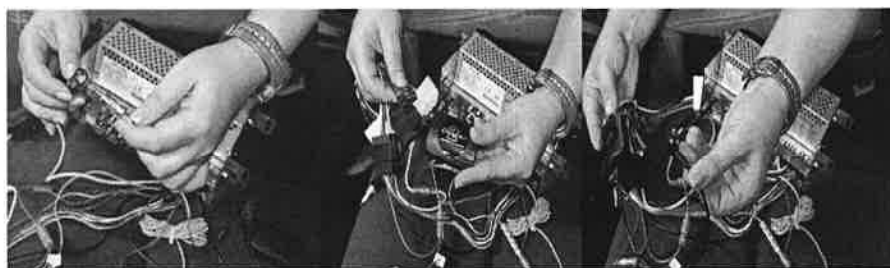
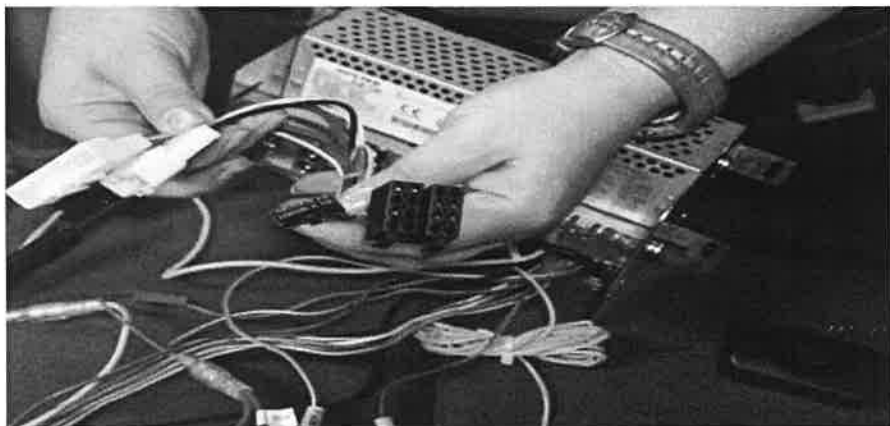

## 5. Dash without Radio.

(Please note that your dash may look different as more than one variant exists)



## 6. Connectors

