



Button Config

Menu Button
Back Button

HDMI Access

Select AUX In from the OEM Source Menu. Hold **MENU** for 2 seconds to switch between OEM screen and Adaptiv Mini HDMI screen. Press **MENU** once to exit HDMI.

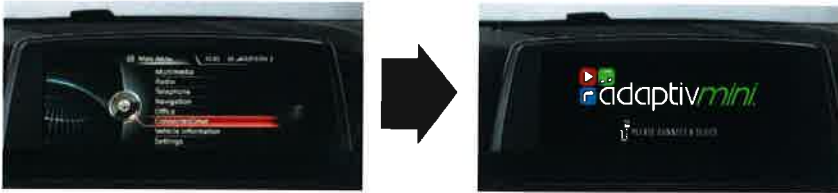

Video In Motion Warning - 10 MPH

Double Press **BACK** to disable the video in motion warning message

Rear and Front Camera Access

From either HDMI mode or OEM mode

1. Select reverse gear for reverse camera
2. Deselect reverse gear - will go to after market front camera (if DIP 2 ON)
Double Press **BACK** to cancel front camera or drive over 10 MPH

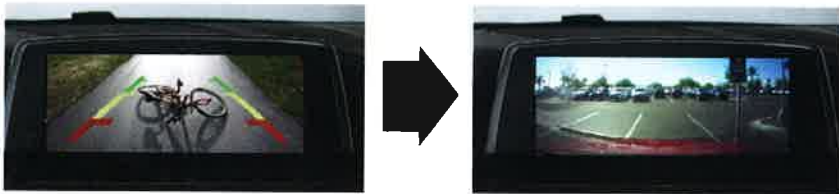

Front Camera Access

Press and hold **BACK** to enter the front camera screen (if DIP 2 is ON). Press **MENU** once to exit front camera.

View Version Number

Hold **MENU** Button for 8 seconds to enter firmware information screen



Adaptiv Mini Fitting & User Guide

ADVM-BM1

BMW NBT 6.5"/8.4"/10.25" Control Display

Vehicles with OEM AUX Input Only. For LVDS HSD+2 Pin Connector Only.

WWW.ADAPTIV-MULTIMEDIA.COM

Adaptiv Mini

Adaptiv Mini allows HDMI & Camera input to the OEM screen.

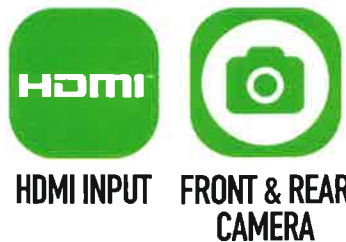

This plug and play Mini interface adds HDMI to connect your Apple or Android device, allowing you to mirror your smartphone display on the vehicle's original screen. Inputs for front and rear aftermarket cameras also come as standard with the Mini.

Application

For BMW vehicles with NBT 6.5"/8.4"/10.25" Control Display.
Vehicles with OEM AUX Input Only. For LVDS HSD+2 Pin Connector Only.

Kit Includes

- Adaptiv Interface
- Vehicle Harness

Prior to installation

Read the manual prior to installation. Technical knowledge is necessary for installation. The place of installation must be free of moisture and away from heat sources. Connects2 cannot be held responsible for the installation of this product.

Technical Support

Connects2 want to provide a fast and suitable resolution should you encounter any technical issues. With this in mind, when contacting Connects2, try to provide as much Information as possible. This will speed up the process and help us to help you.

Please use our dedicated online technical support centre: support.connects2.com

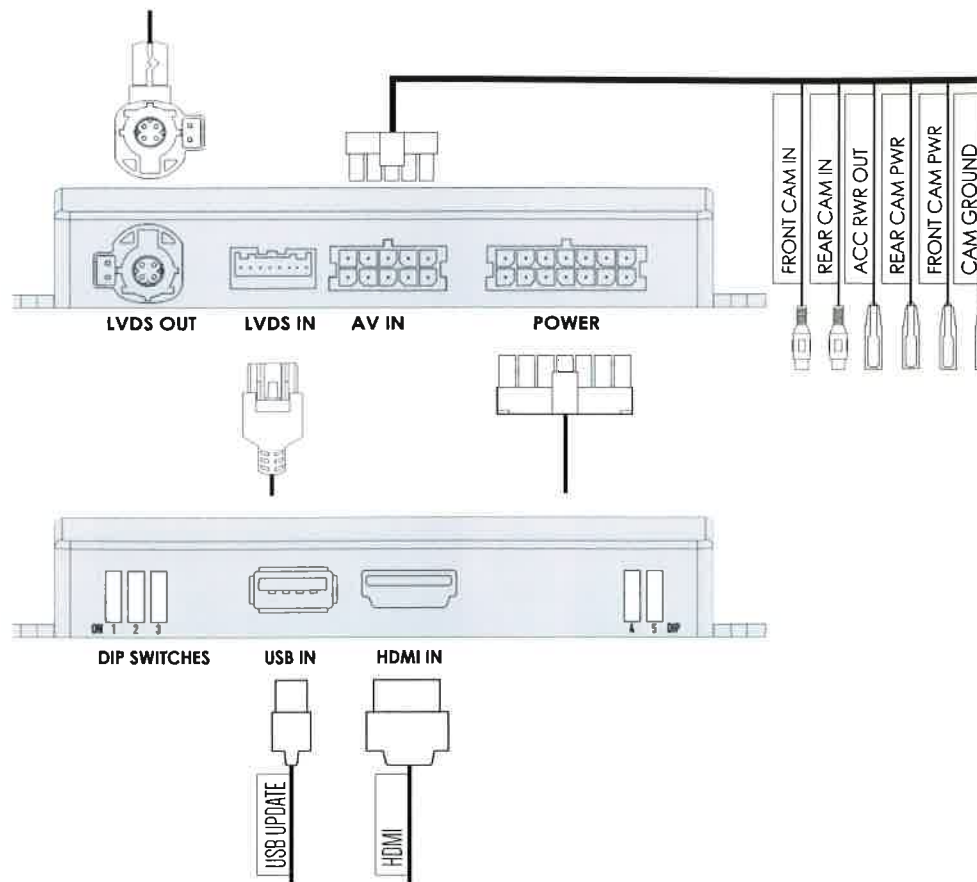

DIP SWITCH SETTINGS

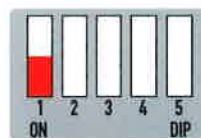

DIP 1
If the vehicle has OEM reverse camera (ON: YES OFF: NO)

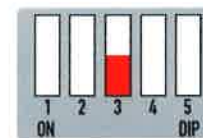

DIP 3
If the vehicle has after-market reverse camera (ON: YES OFF: NO)

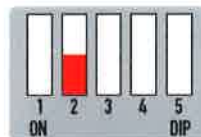

DIP 2
If the vehicle has after-market front camera (ON: YES OFF:NO)

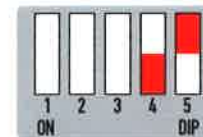

	DIP 4	DIP 5
6.5" Screen	ON	OFF
8.8" & 10.2" Screen	OFF	OFF